

# AluminumNow

New Yacht, Commercial & Military Construction in Aluminum

Email: [info@AluminumNow.com](mailto:info@AluminumNow.com)  
Website: [www.AluminumNow.com](http://www.AluminumNow.com)  
[www.catamaranferries.com](http://www.catamaranferries.com)  
[www.aluminumnowturkey.com](http://www.aluminumnowturkey.com)

Turkey Tel: 90 (0) 252 413 8833/8106  
Fax: 44 20 7681 1505  
Telephone & Fax:- London 44 20 7681 1505  
USA 1 212 208 2579

**Superior Yachts with Breakthrough Technology**

## FastWater™ 48 Wave Piercer PowerCat

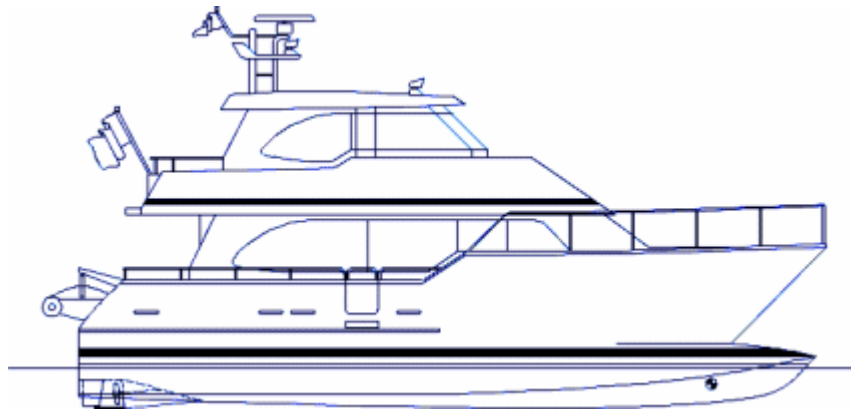

### Specifications

Length Overall	48' 5" – 14.80m
Length Waterline	47' 4" – 14.45m
Beam, Max	21' 0" – 6.40m
Draft	3' 0" – 0.92m
Displacement (Half Load)*	37,200 lbs – 16,910Kg.
Hull L/B Ratio	10.5
Bridge Deck Clearance (center nacelle)	1' 6" / 0.46m - 6' 8" / 2.04m
Fuel Capacity	700 gal. US – 2,800Litres
Water Capacity	300 gal. US – 1,200Litres
Holding Tank Capacity	80 gal. US – 320Litres
Engines: Twin	315 hp Yanmar™ 6LYA-STP

\* Half Load displacement is defined as weight of yacht with all standard equipment, fuel and water tanks at half full.

Specifications may change without notice

EuroTech™'s FastWater™ 48 Wave Piercer PowerCat was designed to offer a long range/live-a-board motor cruiser with high stability both when under way and at anchor, a soft ride in a seaway, shallow draft with full propeller protection, and home like accommodations. The streamlined pilothouse with Portuguese bridge offers a climate controlled helm station as well as additional living space.

To achieve the desired qualities the FastWater™ 48 Wave Piercer PowerCat was developed so that it maintains all of the living spaces on or above the main deck with only machinery and tanks in the hulls. This configuration allows the individual hulls to be narrower offering improved speed and motion, while reducing overall weight. It also provides for improved isolation of noise, heat, odors and vibrations, typically experienced with vessels that share living, and mechanical spaces. Additionally the hulls can be outfitted with larger than usual tank capacities and the weight of these heavy items can be kept low and concentrated amidships. These features when combined with the generous overall beam result in a lower and more centralized center of gravity, yielding better ultimate stability and reduced pitching in a seaway.

The design of the FastWater™ 48 Wave Piercer PowerCat incorporates semi-displacement Wave Piercer hulls that deliver unparalleled performance and sea kindliness at both low and high speeds. The propellers and rudders are protected and shallow draft is maintained through the use of shallow tunnels and protective skegs while the underside of the bridge deck is v-shaped in order to minimize impact with waves. Powered with twin 315hp diesels, the FastWater™ 48 will be a breeze to handle with the standard electronic shift/throttles engine controls and bow thruster.

The hull and deck of the FastWater™ 48 Wave Piercer PowerCat have been designed for strength and light-weight utilizing EuroTech's *FastForm*™ computer aided solid sheet aluminum construction technique, *Alustar*™ 5059 alloy and *CeRam-Kote*™ protective coating. The internal structure consists of aluminum longitudinal stringers and aluminum ring frames with honeycomb-cored fiberglass center sectioned bulkheads. The entire hull and deck are insulated for thermal and acoustic considerations. The interior structural soles and bulkheads are of honeycomb cored fiberglass sandwich construction and the interior joiner work is a combination of lightweight wood veneered panels with hardwood trim. This hybrid method of construction offers light weight, with high strength, and when combined with EuroTech's *SemTech*™ (systems, equipment & materials) advanced outfitting technology provides a seaworthy vessel that is truly easy to maintain and operate.

## Construction

- Hull and deck constructed of *Alustar*™ 5059 aluminum alloy, utilizing *SailTech FastForm*™ construction method.
- All aluminum surfaces interior below waterline and exterior hull coated with *CeRam-Kote*™.
- High gloss urethane topcoat on all hull and deck surfaces.
- Silica nonskid incorporated into *CeRam-Kote*™ on horizontal deck surfaces.

## Electrical

- Electrical System by *Mastervolt*™
- All AC-DC wiring tinned and irradiated.
- All wiring run through isolated conduit.
- Two 90 amp alternators with three-step regulation and temperature sensing.
- *Mastervolt*™ AC-DC electrical panel with LED digital meters.
- *YachtGard*™ AC-DC surge protection
- *Mastervolt*™ 10kw isolation transformer.

## Construction Con't

- Internal structure consisting of longitudinal stringers bonded with methacrylate adhesives or welded, and welded aluminum ring frames, with honeycomb cored composite center sections.
- Entire hull and deck is insulated for thermal and acoustic considerations by *Novicon Industries*™.
- Watertight crash bulkheads/compartments in the bow of each hull.
- Interior of all deck and anchor lockers coated with polyurethane protective lining.
- Twin aluminum rudders.
- Aluminum rudder shafts with *PYI*™ bearings.
- Shallow propeller tunnels in each hull with integral propeller shaft log and protection skeg.
- Antifouling paint below waterline and running gear.
- Optional 10-year structural warranty.
- Construction in accordance with *ABYC*.
- Factory commissioning.

## Mechanical

- Twin 315 hp *Yanmar*™ marine diesel engines with C-type engine panels. (5 yr. Warranty)
- *Maxpower*™ 12vdc bowthruster
- *Floscan*™ fuel monitoring system
- *Glendinning*™ automatic engine synchronizers
- *PYI*™ flexible couplers, engine mounts, and driplless stuffing boxes.
- Stainless steel propeller shafts, with *Spurs*™ weed/line cutters.
- Four blade bronze propellers.
- *Reverso*™ oil change system.
- *Puratec*™ fuel purification system.
- *Groco Hydromatic*™ seawater intake/strainer system.
- Twin single lever *Glendinning*™ electronic engine shift/throttle controls.

## Electrical Con't

- 50amp 220vac shore service split to 120vac.
- Dockside cable TV and telephone.
- *Glendinning Cablemaster*™ shore cord storage system for shore power and TV/telephone cable.
- 800 amp maintenance free gel cell house battery bank (2 volt cells), with emergency parallel switch.
- Two separate 85 amp gel cell engine starting batteries.
- Battery isolator.
- *Mastervolt*™ 2000 watt sine wave inverter.
- *Mastervolt*™ 80 amp battery charger with temperature sensing.
- *Mastervolt*™ 12 kw AC generator with water gas separator exhaust system and *Reverso*™ oil change pump.
- *CruiseAir*™ 41,000 btu reverse cycle air conditioning system ducted to main deck, upper deck, and engine rooms.
- *Electro-Guard*™ cathode protection system.
- *Taylorbrite*™ 12vdc CCF interior lighting with dimmer switches.
- 12vdc running lights.
- LED courtesy lighting throughout including all hanging lockers.
- Remote shut-off for propane.
- 12vdc interior fans for each cabin space.
- Central vacuum cleaner system.

## Plumbing

- *Sea Tech*™ fresh water plumbing with manifold system.
- *ITT Jabsco*™ water pressure system.
- *Sealand Vacuflush*™ head and holding tank systems including level gauge, y-valve, macerator pump, and deck fitting.
- Two polyethylene water tanks with level gauges.

## Mechanical Con't

- Engine room exhaust blowers.
- Engine spare parts and workshop manual.
- *Teleflex*<sup>TM</sup> hydraulic steering system
- Two independent aluminum baffled fuel tanks with inspection ports, polyester coating coating and level gauge.
- Twin *Fireboy*<sup>TM</sup> MA-2 manual/automatic fire extinguishing systems with automatic engine shut downs.

## Plumbing Con't

- Separate sealed shower sumps with automatic pump out.
- *Isotemp*<sup>TM</sup> twelve-gallon 120 vac water heater with engine heat exchanger.
- Four 2000gph 12vdc bilge pumps with auto switch.
- Two *Whale Gusher*<sup>TM</sup> manual bilge pumps.
- Manual fresh water foot-pump in galley.
- Two 20 lb. aluminum propane bottles with gauge.
- All seacocks *Forespar Marelon*<sup>TM</sup>.
- Hot and cold deck shower in cockpit at transom steps.
- Dockside water at transom steps with hose and in-line filter.
- Fresh water washdown in cockpit.
- Seawater anchor washdown.

## Main Salon - port

- U-shaped galley with easy access to cockpit and interior.
- Generous counter space fabricated of a decorative solid surfacing material.
- Undermount double sink with hot and cold mixer/spray faucet.
- Front opening *WAECO/Adler Barbour*<sup>TM</sup> AC/DC refrigerator/freezer.
- *Broadwater*<sup>TM</sup> four burner propane stove and oven with drop in cover.
- Overhead galley exhaust fan.
- Upper and lower cabinet storage.
- Space for microwave and trash compactor.
- Breakfast bar with seating
- Space for entertainment center and LCD TV.

## Main Salon - starboard

- L-shaped settee with folding dining table.
- Access to day head.

## Foredeck, Side Decks, Cockpit and Transoms

- Aluminum bow and side rails.
- Decks cambered for quick draining with integral toe rail and *HullShield*<sup>TM</sup> rubrail.
- Aluminum bow, amidships and stern cleats.
- Foredeck bench seating and cushions with integral step to centerline stairway to pilothouse.
- Full height aft cockpit and side deck bulwarks with freeing ports and hawse rings.
- Integral steps from port and starboard side decks up to foredeck.
- 12 vdc transom dinghy davits.
- Aft cockpit L-shaped settee with storage and table.
- Upper deck L-shaped settee with storage and table.
- Cockpit sink with hot and cold mixe
- Cockpit wet locker.

## Main Salon - forward

- Stairway with banister to upper deck.
- Separate access to port and starboard staterooms and heads.

## Staterooms & Heads

- Port stateroom has a queen size berth accessible from both sides with large storage and wire bins below, accessed by hinged bunk top supported by gas springs.
- Cedar lined hanging lockers.
- Ventilation opening port with screen.
- Multiple drawers.
- TV/entertainment center space.
- Port stateroom head has *Sealand Vacuflush™* toilet, separate shower stall, mirror and vanity, with decorative solid surface countertop and molded sink.
- Starboard stateroom has two single berths with large storage and wire bins below, accessed by hinged bunk top supported by gas springs.
- Cedar lined hanging locker.
- Ventilation opening port with screen.
- Multiple drawers.
- TV/entertainment center space.
- Starboard head has *Sealand Vacuflush™* toilet, shower space, mirror and vanity, with decorative solid surface countertop and molded sink.
- Built-in *Splendide™* washer/dryer.

## Upper Deck

- Enclosed pilothouse with tinted tempered opening glass windows with screens.
- Overhead lighting.
- Overhead opening hatches with screens and blinds.
- Storage cabinets.
- Triple windshield wipers with washers.
- Port and starboard doors to access Portuguese bridge.

## Foredeck, Side Decks, Cockpit and Transoms Con't

- *Marinedeck 2000™* exterior synthetic simulated teak decking on aft deck and transom steps.
- Tinted tempered glass sliding door with screen to access main salon.
- Dual swim platforms with integral folding/telescoping swim ladder and cutaway for dinghy access.
- *Lighthouse™ 1501* stainless steel 12vdc horizontal anchor windlass mounted in recessed anchor well with dual chain gypsy and capstan, reversing, deck switches, remote with chain counter, and anchor washdown.
- Dual Access port and starboard to engine space.
- Dual recessed anchor storage rollers.
- Anchor bridle with attachment eyes at bows.
- One model #140 *Spade™* 33 lb. aluminum anchor with 200 feet of 3/8" stainless steel anchor chain, and one model #100 *Spade* 20 lb. aluminum anchor with 150 feet of 5/8" nylon rode and 20 feet of 3/8" stainless steel anchor chain.
- Four fenders and four braided docklines

## Upper Deck Con't

- Double helm seat, destroyer wheel, engine panels, and engine controls.
- Console with 6" binnacle compass and room for navigation electronics.
- Upper deck accessible by inside and fore and aft deck stairways.
- L-shaped settee with storage under.
- Two reclining chairs.
- Sliding glass door to access aft upper deck with aluminum railing, and access to exterior stairway to cockpit.
- Three solar vents.

## Engine Rooms

- Separate engine room port and starboard with access from on deck.
- Sound and thermal insulation by *Novicon Industries™*.
- Rubberized synthetic sole.
- Watertight bulkhead.
- Separate 2000gph bilge pumps.
- Enclosed engine sumps.
- Storage shelves and lockers.
- Fresh water faucet.
- Tool storage.
- Paper towel holder.
- 110vac outlet.
- 12v fan.
- Mini work bench and vice.
- Ducted for air conditioning.
- Safety Equipment

## Options

- Port and starboard remote bridge wing stations with engine and bow thruster controls.
- Aft deck remote engine and bow thruster controls.
- Stowaway gangways port and starboard.
- *MST Guardian™* engine flush system.
- *Spectra™* 400 watermaker.
- Navigation and communications electronics.
- Stereo and TV.
- Solar panels.
- Microwave.
- Trash compactor.
- Icemaker.

Upper Deck

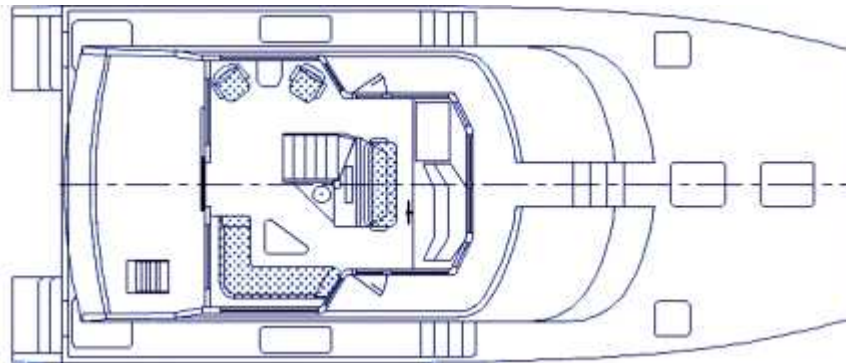

Main Deck

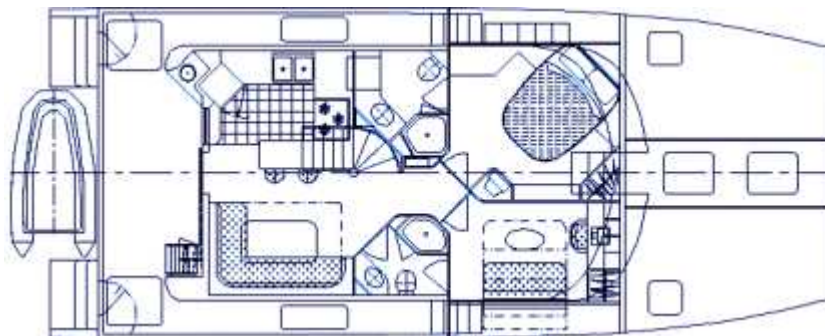

Note: Specifications are subject to change without notice. The builder reserves the right to make alterations as considered desirable. No such alterations are to be considered retroactive with respect to yachts delivered, under construction, or under contract. Draft, displacement, and performance can all vary based on load. This is neither a warranty nor are any warranties implied. The manufacturers liabilities are strictly limited to the warranty as described in Limited Warranty documents provided

	<u>Maximum Speed @ 3800 RPM</u>	<u>Cruise Speed @ 3000 RPM</u>	<u>Cruise Speed @ 2500 RPM</u>
Performance Speed	25.4 Knots (29.2 mph)	18.2 Knots (20.9 mph)	15.5 Knots (17.8 mph)
Total Fuel Consumption	33.2 gal/per hr	17.0 gal/per hr	10.2 gal/per hr
Range	535 nm	751 nm	1061 nm

These are preliminary performance predictions, which are based upon half load conditions, and are subject to change depending upon the final weight of the vessel. Naturally, it must be understood that each model when fully loaded will attain lower speeds, and that speed will increase as fuel, water and stores are used. However, it is rare that one runs at full throttle when fully loaded and heading out for an extended voyage. Range will be greatly increased at mid range speeds and for the weekender or short-range cruiser; it is not always necessary to travel with full fuel and water tanks.